

E - Z FEED QUICK DISCONNECT FEEDER END ADAPTOR KITS 4820G - 4995

INSTALLATION INSTRUCTIONS

1. Quick Disconnect Feeder End may be connected directly to a Bernard adaptor by threading quick disconnect directly into adaptor. Make all necessary power, control, and gas connections.
2. Quick Disconnect Feeder End, PN 4920 is supplied with two long guide tubes (PN 478 and 479) of different I.D.'s which must be cut to the proper length.
3. Select the proper guide tube I.D. from the table below.
 - .023-.052 Electrode Small I.D.
 - .062-1/8 Electrode Large I.D.
4. Install taper end toward feed rolls. If electrodes below .045 are being used, it may be advisable to grind a chisel point on the tapered end to guide electrode closer to the feed rolls.
5. Procedure to determine cut length for guide tube that extends beyond quick disconnect (Refer to Illustration 1):
 - A. Mark tube at point even with end of quick disconnect body.
6. Procedure to determine cut length for guide tube recessed within quick disconnect (Refer to Illustration 2):
 - A. With small rule, measure amount guide tube is within quick disconnect body.
 - B. Using formula below, cut guide tube to proper length. Shorten guide tube from end opposite taper.
 - C. 1-1/2" minus distance measured inside the quick disconnect body equals length to be shortened.
7. Insert the guide tube in the adaptor. Check guide tube length as indicated in Illustration 3 for proper fit and tighten set screw. E-Z Feed Adaptor Kits are supplied with pre-cut guide tubes for specific machines, as indicated below.

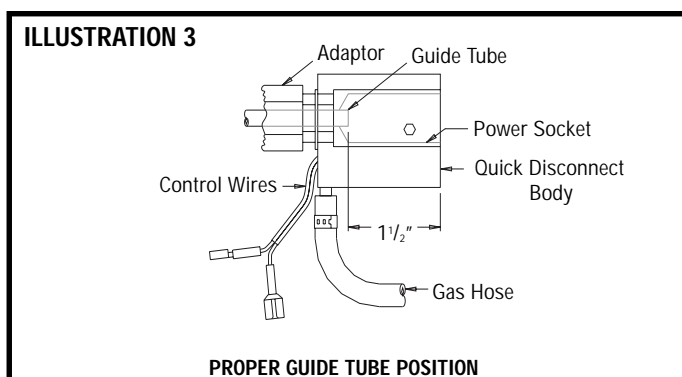
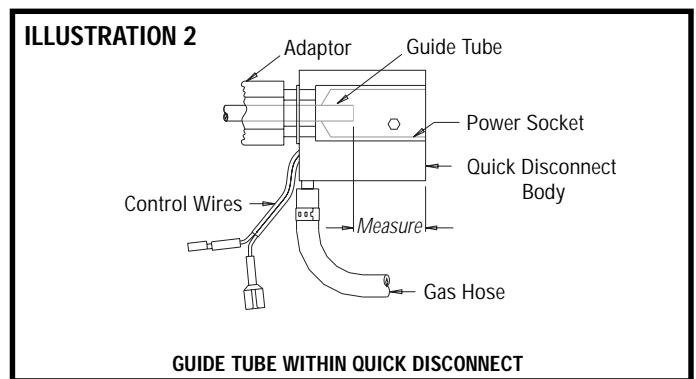
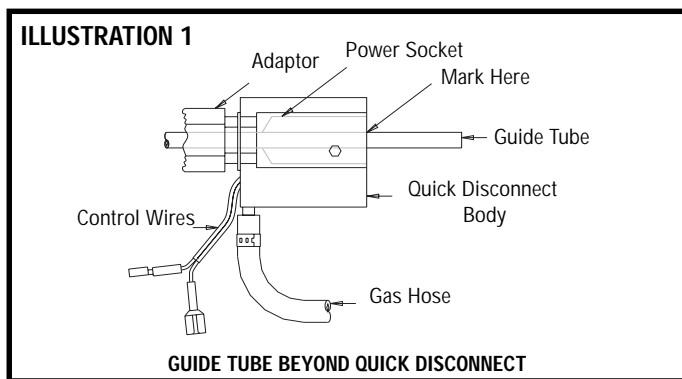

0"	1/4"	1/2"	3/4"	1"	1 1/4"	1 1/2"	1 3/4"	2"

Bernard
An Illinois Tool Works Company
449 West Corning Road, Box 667
Beecher, Illinois 60401-0667 U.S.A.
708-946-2281 Fax 708-946-6726
800-946-2281 Customer Support
800-646-6726 Fax Orders
www.bernard-welding.com

4820G

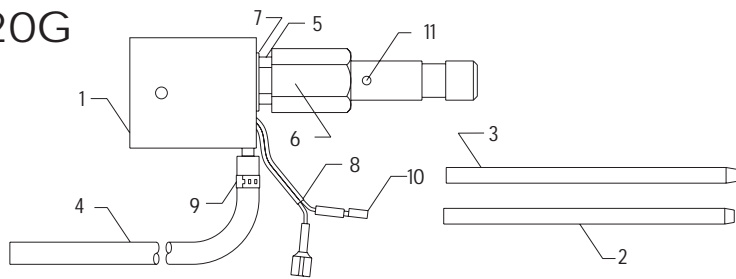

FOR USE ON	ITEM	PART NO.	DESCRIPTION
Hobart	1	4893	Body, w/Gas Barb & O-Ring
Beta-Mig	2	4850	Guide Tube, Small I.D.
200-2000	3	373	Guide Tube, Large I.D.
Models 17 & 19	4	1571	Gas Hose
	5	4908	Socket
Miller	6	5108	Adaptor Body
Migman 105	7	4912	Snap Ring
W/pre-cut guide tubes	8	4942	Wire Assembly
	9	1930	Oetiker Clamp
	10	1346	Terminals
	11	396	Set Screw

4820K

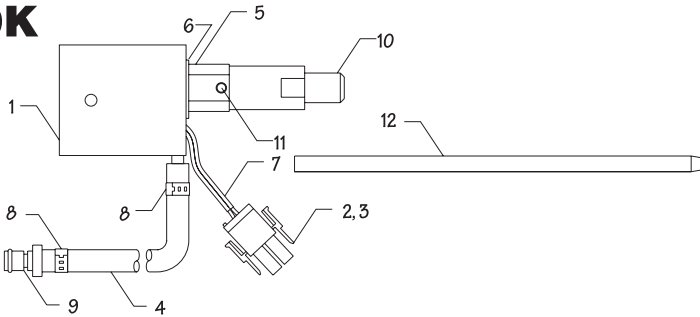

FOR USE ON	ITEM	PART NO.	DESCRIPTION
ESAB	1	4893	Body, w/Gas Barb & O-Ring
Me-2	2	9394	Housing, Male Connector
Migmaster 180	3	9395	Pin, Connector
CENTURY	4	1571	Gas Hose
100, 130, 150, 160	5	4972	Socket
200, 225, 250	6	4912	Snap Ring
powermate225	7	4942	Wire Assembly
AIRCO	8	1930	Oetiker Clamp
Dippak 250, 300	9	9713	Plastic Gland
MIGhty 2E, 4HD, IIE, IVHD	10	4805	Adaptor Body
CEMIG 169T, 200T	11	396	Set Screw
POWCON	12	4852	Guide Tube, Small I.D.
PDP1, powerdrive1, power drive1E, DAV Mig			

4820L

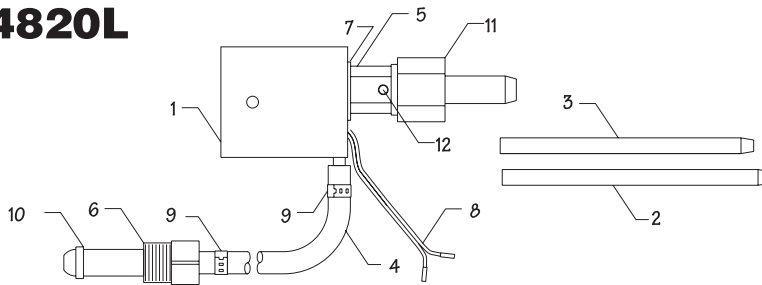

FOR USE ON	ITEM	PART NO.	DESCRIPTION
L-TEC	1	4893	Body, w/Gas Barb & O-Ring
mig-31	2	194	Guide Tube, Small I.D.
swm-30	3	371	Guide Tube, Large I.D.
swm-31	4	1571	Gas Hose
	5	4972	Socket
	6	1566	Gas Nut
	7	4912	Snap Ring
	8	4942	Wire Assembly
	9	1930	Oetiker Clamp
	10	663	Hose Gland
	11	4998	Adaptor Body
	12	396	Set Screw

4820N

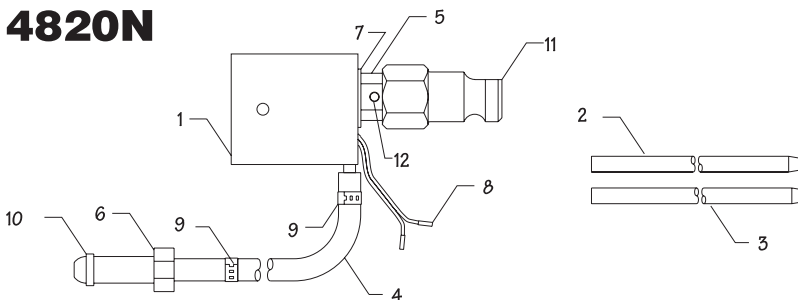

FOR USE ON	ITEM	PART NO.	DESCRIPTION
Panasonic	1	4893	Body, w/Gas Barb & O-Ring
YW501FK	2	4958	Guide Tube, Small I.D.
	3	379	Guide Tube, Large I.D.
National	4	1571	Gas Hose
most models	5	4972	Socket
	6	366	Gas Nut
	7	4912	Snap Ring
	8	4942	Wire Assembly
	9	1930	Oetiker Clamp
	10	663	Hose Gland
	11	7115	Adaptor Body
	12	396	Set Screw

4820P

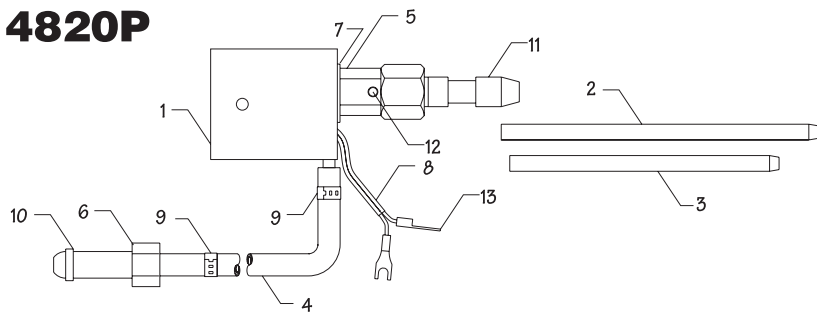

FOR USE ON	ITEM	PART NO.	DESCRIPTION
OTC	1	4893	Body, w/Gas Barb & O-Ring
most models	2	4958	Guide Tube, Small I.D.
	3	379	Guide Tube, Large I.D.
Gelco	4	1571	Gas Hose
all models	5	4972	Socket
	6	366	Gas Nut
	7	4912	Snap Ring
	8	4942	Wire Assembly
	9	1930	Oetiker Clamp
	10	663	Hose Gland
	11	7124	Adaptor Body
	12	396	Set Screw
	13	4261	Spade Terminal

4920

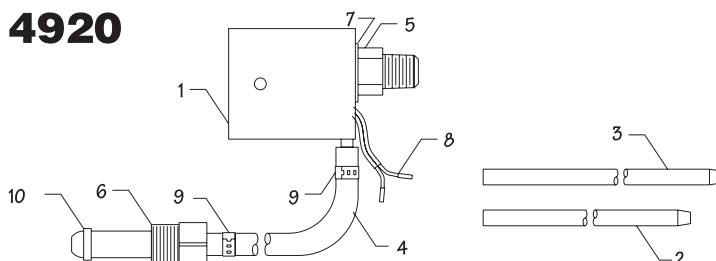

FOR USE ON	ITEM	PART NO.	DESCRIPTION
Quick Disconnect, feeder end w/guide tubes (2)	1	4893	Body, w/Gas Barb & O-Ring
	2	478	Guide Tube, Small I.D.
	3	479	Guide Tube, Large I.D.
Fits all existing Bernard adaptors	4	1571	Gas Hose
	5	4908	Socket
	6	1566	Gas Nut
	7	4912	Snap Ring
	8	4942	Wire Assembly
	9	1930	Oetiker Clamp
	10	663	Hose Gland

4970

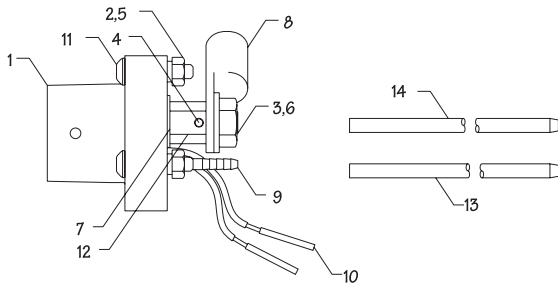

FOR USE ON	ITEM	PART NO.	DESCRIPTION
ESAB, most models	1	4971	Feeder Mount
	2	1456	Hex Nut
	3	4974	Hex Jam Nut
W/pre-cut guide tubes	4	396	Set Screw
	5	3613	Lock Washer
	6	4975	Flat Washer
	7	4912	Snap Ring
	8	B-120	Solder Type Lug
	9	4214	Gas Barb Assy. (w/4907 O-Ring)
	10	4942	Wire Assembly
	11	4973	Button Head Screw
	12	4972	Power Socket
	13	478	Guide Tube, Small I.D.
	14	479	Guide Tube, Large I.D.

4970A

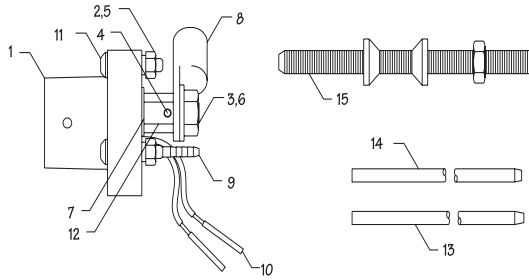

FOR USE ON	ITEM	PART NO.	DESCRIPTION
Universal flange mount quick disconnect	1	4971	Feeder Mount
	2	1456	Hex Nut
	3	4974	Hex Jam Nut
	4	396	Set Screw
includes universal centering device for most European feeders	5	3613	Lock Washer
	6	4975	Flat Washer
	7	4912	Snap Ring
	8	B-120	Solder Type Lug
	9	4214	Gas Barb Assy. (w/4907 O-Ring)
	10	4942	Wire Assembly
	11	4973	Button Head Screw
	12	4972	Power Socket
	13	478	Guide Tube, Small I.D.
	14	479	Guide Tube, Large I.D.
	15	4989	Centering Kit Complete

4981

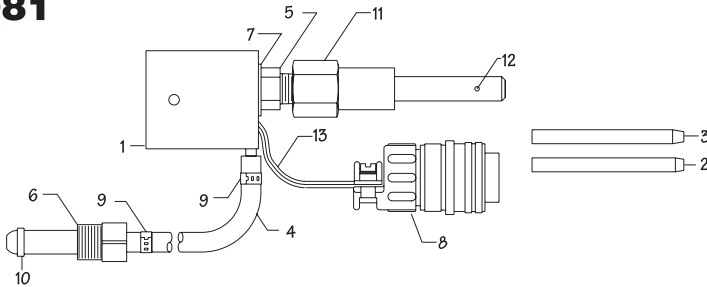

FOR USE ON	ITEM	PART NO.	DESCRIPTION
Lincoln LN4, LN-5, LN-6, LN-8, LN-9	1	4893	Body, w/Gas Barb & O-Ring
	2	4951	Guide Tube, Small I.D.
	3	4961	Guide Tube, Large I.D.
W/pre-cut guide tubes and plugs	4	1571	Gas Hose
	5	4908	Socket
	6	1566	Gas Nut
	7	4912	Snap Ring
	8	1694	Lead Set (Includes 4942)
	9	1930	Oetiker Clamp
	10	663	Hose Gland
	11	1381	Adaptor Body
	12	1384	Set Screw
	13	4942	Wire Assembly

4982

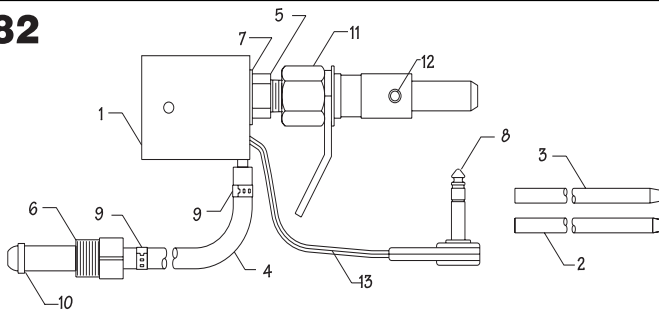

FOR USE ON	ITEM	PART NO.	DESCRIPTION
Hobart, all models except 200	1	4893	Body, w/Gas Barb & O-Ring
	2	4952	Guide Tube, Small I.D.
	3	4962	Guide Tube, Large I.D.
W/pre-cut guide tubes and plug	4	1571	Gas Hose
	5	4908	Socket
	6	1566	Gas Nut
	7	4912	Snap Ring
	8	1692	Lead Set (Includes 4942)
	9	1930	Oetiker Clamp
	10	663	Hose Gland
	11	1362	Adaptor Body
	12	396	Set Screw
	13	4942	Wire Assembly

4983

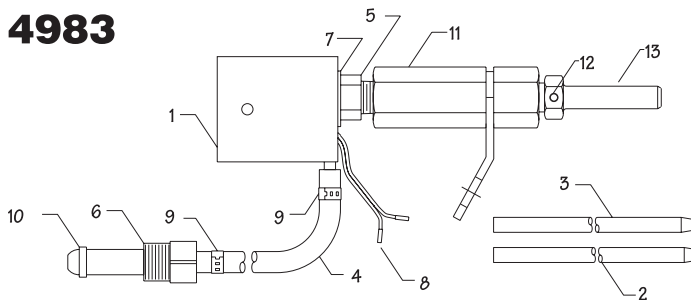

FOR USE ON	ITEM	PART NO.	DESCRIPTION
Miller, 10 & 30 Series	1	4893	Body, w/Gas Barb & O-Ring
70 & 80 Series	2	4953	Guide Tube, Small I.D.
	3	4963	Guide Tube, Large I.D.
Machinery & Weldor MHFC-H, MHFC-R1	4	1571	Gas Hose
	5	4908	Socket
	6	1566	Gas Nut
W/pre-cut guide tubes	7	4912	Snap Ring
	8	4942	Wire Assembly
	9	1930	Oetiker Clamp
	10	663	Hose Gland
	11	1363	Adaptor Body
	12	396	Set Screw
	13	489	Adaptor Shank

4984

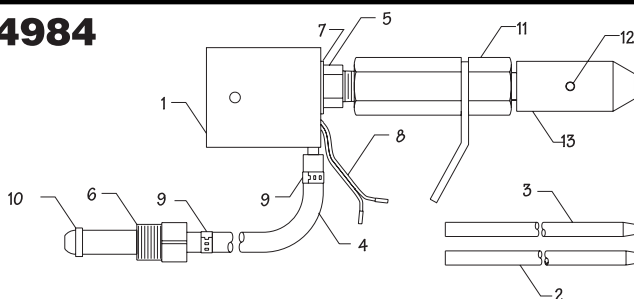

FOR USE ON	ITEM	PART NO.	DESCRIPTION
Linde, SWM-11, 11B, 23, 24, 25, 26, 35, SEH-3, SEH-5, SEH-10	1	4893	Body, w/Gas Barb & O-Ring
Digimig	2	4955	Guide Tube, Small I.D.
	3	4965	Guide Tube, Large I.D.
W/pre-cut guide tubes	4	1571	Gas Hose
	5	4908	Socket
	6	1566	Gas Nut
	7	4912	Snap Ring
	8	4942	Wire Assembly
	9	1930	Oetiker Clamp
	10	663	Hose Gland
	11	1363	Adaptor Body
	12	396	Set Screw
	13	1170	Adaptor Shank

4984A

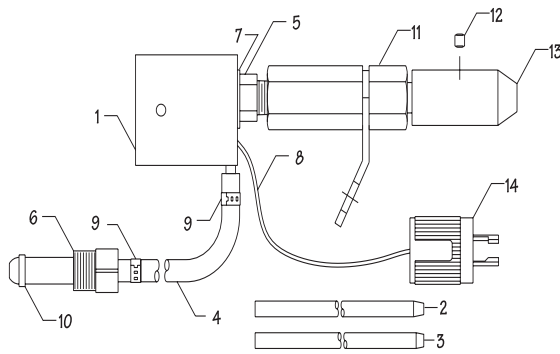

FOR USE ON
Digimig

ITEM	PART NO.	DESCRIPTION
1	4893	Body, w/Gas Barb & O-Ring
2	4955	Guide Tube, Small I.D.
3	4965	Guide Tube, Large I.D.
4	1571	Gas Hose
5	4908	Socket
6	1566	Gas Nut
7	4912	Snap Ring
8	4942	Wire Assembly
9	1930	Oetiker Clamp
10	663	Hose Gland
11	1363	Adaptor Body
12	396	Set Screw
13	1170	Adaptor Shank Plug
14	4979	Plug

4984B

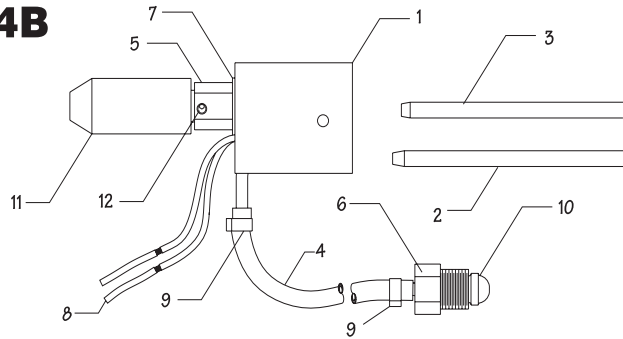

FOR USE ON
Linde

ITEM	PART NO.	DESCRIPTION
1	4893	Body, w/Barb & O-Ring
2	4955	Guide Tube, Small I.D.
3	4965	Guide Tube, Large I.D.
4	1571	Gas Hose
5	4972	Power Socket
6	1566	Gas Nut
7	4912	Snap Ring
8	4942	Wire Assembly
9	1930	Clamp
10	663	Hose Gland
11	1170A	Adaptor Shank
12	396	Set Screw

4986

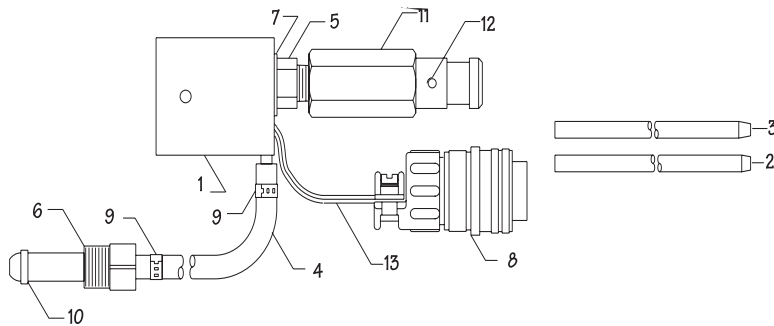

FOR USE ON
Lincoln LN-7,
SP-200, LN-22

W/pre-cut
guide tubes and plug

ITEM	PART NO.	DESCRIPTION
1	4893	Body, w/Gas Barb & O-Ring
2	4956	Guide Tube, Small I.D.
3	4966	Guide Tube, Large I.D.
4	1571	Gas Hose
5	4908	Socket
6	1566	Gas Nut
7	4912	Snap Ring
8	1694	Lead Assembly (includes 4942)
9	1930	Oetiker Clamp
10	663	Hose Gland
11	295	Adaptor Body
12	396	Set Screw
13	4942	Wire Assembly

4988

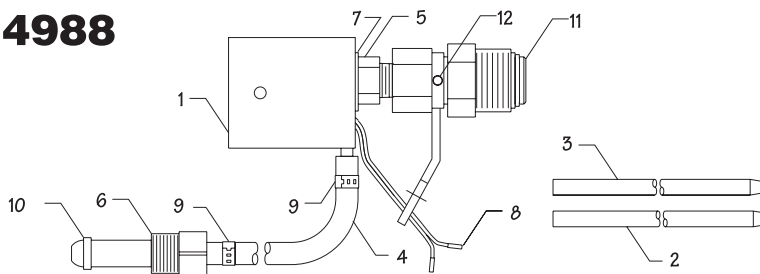

FOR USE ON
Airco AHF-N,
AHF-R, AHF-S,
AHF-T, AHF-U,
AHF-V, AHF-J,
AHF-L, AHF-W

(W/pre-cut guide
tubes)

ITEM	PART NO.	DESCRIPTION
1	4893	Body, w/Gas Barb & O-Ring
2	4953	Guide Tube, Small I.D.
3	4963	Guide Tube, Large I.D.
4	1571	Gas Hose
5	4908	Socket
6	1566	Gas Nut
7	4912	Snap Ring
8	4942	Wire Assembly
9	1930	Oetiker Clamp
10	663	Hose Gland
11	4825	Adaptor Body
12	396	Set Screw

4995

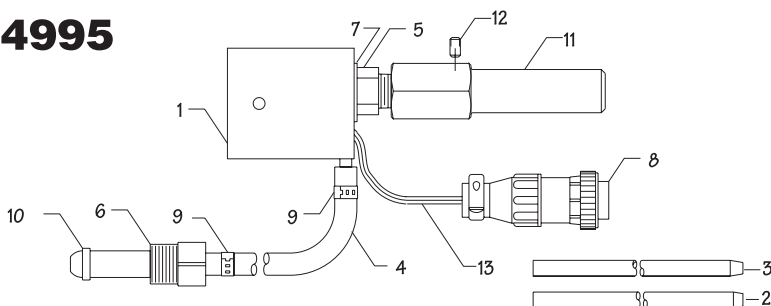

FOR USE ON
Miller 542 GL
Swing Arc, part
079-548
Porta-MIG
Millermatic 40, 50
Migmate
Millermatic 130
Miller S-32S &
S-32P

W/pre-cut guide
tubes and plugs

ITEM	PART NO.	DESCRIPTION
1	4893	Body, w/Gas Barb & O-Ring
2	4958	Guide Tube, Small I.D.
3	4968	Guide Tube, Large I.D.
4	1571	Gas Hose
5	4908	Socket
6	1566	Gas Nut
7	4912	Snap Ring
8	4996	Lead Assembly (includes 4942)
9	1930	Oetiker Clamp
10	663	Hose Gland
11	1294	Adaptor Body
12	396	Set Screw
13	4942	Wire Assembly