

Flux-Core Option for TOUGH GUN™ MIG Guns

TOUGH GUN 450 and 550 amp Semi-Automatic Air-Cooled MIG Guns can be modified for flux-core welding by using the parts listed below. This flux-core option is an alternative to the TOUGH GUN Self-Shielded Gun (discontinued on September 1, 2010).

SPECIFIC PART NUMBERS:

FLUX-CORE GOOSENECKS

NOTE: Self Shielded style of flux-core necks (435-series) will not be offered past Sept. 1, 2010

- Stock Code "M" (made to order – up to 3 days)
- Product is Category "A" item

400 amp Part Numbers

- 405-45F
- 405-60F
- 405-80F

500 amp Part Numbers

- 505-45F
- 505-60F
- 505-80F



RETAINING HEAD

- Part Number - 404-23
- Stock Code "N" (normally stocked)
- Product is Category "A" item
- Package quantity = 25



NOZZLE

- Part Number - 401-21
- Stock Code "N" (normally stocked)
- Product is Category "A" item
- Package quantity = 10



HEAT SHIELD

- Part Number - 421
- Stock Code "N" (normally stocked)
- Product is Category "A" item

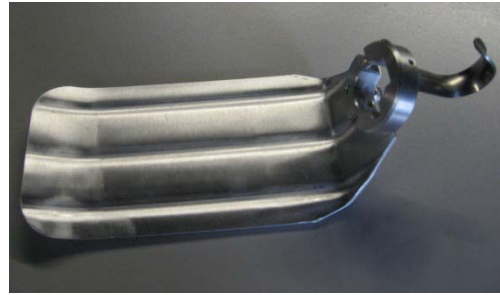

SAMPLE REPLACEMENT GUN NUMBERS:

400 amp gun

- **F4010-45**

500 amp gun

- **F5010-45**